



S-25-B (Back Inlet) Welding Gas Regulator

Features

- Replaceable Inner Tube
- Bulk Line System
- Precision Control
- Lockable Knob Design
- Fittings
 - Inlet – 1/4 NPT (Back Inlet)
 - Outlet – Female Inert (Bottom Outlet)
- Max. Inlet Pressure 200 P.S.I.

Options

- Mounting Kit

Mounting Options

- Pipe Line
- Wire Feeder

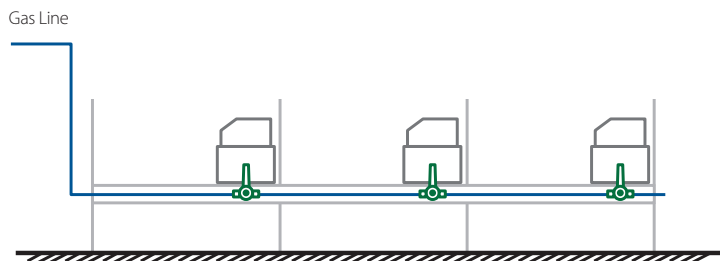
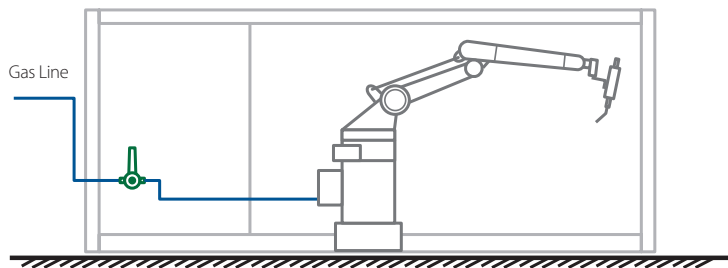

Money Savings



Improve Weld Quality



Protect Our Environment



Save Time

Performance Guaranteed

Every Syner-G system is guaranteed to deliver both savings and improvement of gas control. We are confident you will prove the benefit of your Syner-G welding gas regulator – or we'll give you your money back... Guaranteed!

Warranty

All Syner-G products are warranted for 2 years from the date of shipment. This is an all-inclusive warranty, on all components. If your welding gas regulator malfunctions for any reason due to manufacturers defects, just send it back for a replacement.

Syner-G S-25-B (Back Inlet) Welding Gas Regulator



Specifications

Fluid Media – Gas compatible w/ materials

Max Inlet Pressure – 200 PSI (14 bar)

Outlet Pressure Range – 0-20 PSI (0-1.5 bar)

Inlet – 1/4 NPT

Outlet – 5/8 -18 (m)

comes standard with 1 female inert fitting

Weight – 2.0 lbs.

Flow Capacity – Cv=.06

Ambient Operating Temp. – -15° to +165°F

Leak Rate – Bubble tight

Inlet Proof Pressure – 150% Rated pressure

Outlet Proof Pressure – 150% Rated pressure

Design Based Pressure – 400% Rated pressure

Flow Tube Graduations – 5 CFH

Materials

Body – Brass 385

Bonnet – Aluminum

Diaphragms – Nitrile Reinforced Rubber

Seat – UHMWPE

O-Rings – N70

Adjusting Knob – Aluminum

Dimensions

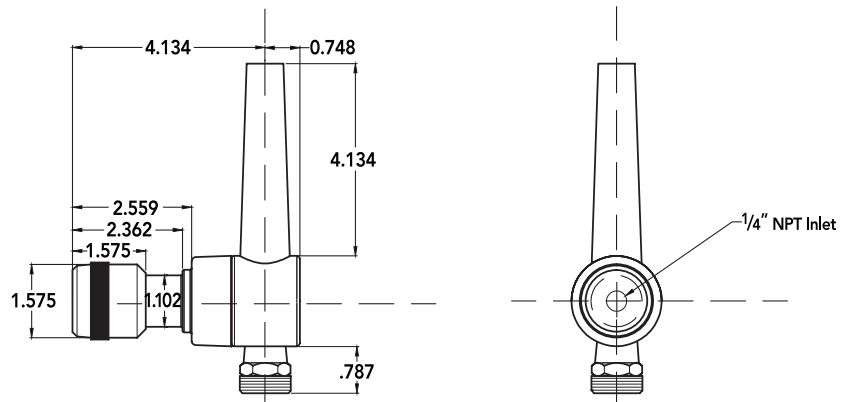

RoboVent is part of the Rensa Filtration family of companies—
air filtration partners who manufacture best-in-class solutions to
help keep environments safe and industries thriving.

For more information visit www.rensafiltration.com.

RENSA FILTRATION

ROBOVENT.COM
888.ROBOVENT

RoboVent®
Improving Lives through Clean Air.™